

3400 Raymond-Lasnier

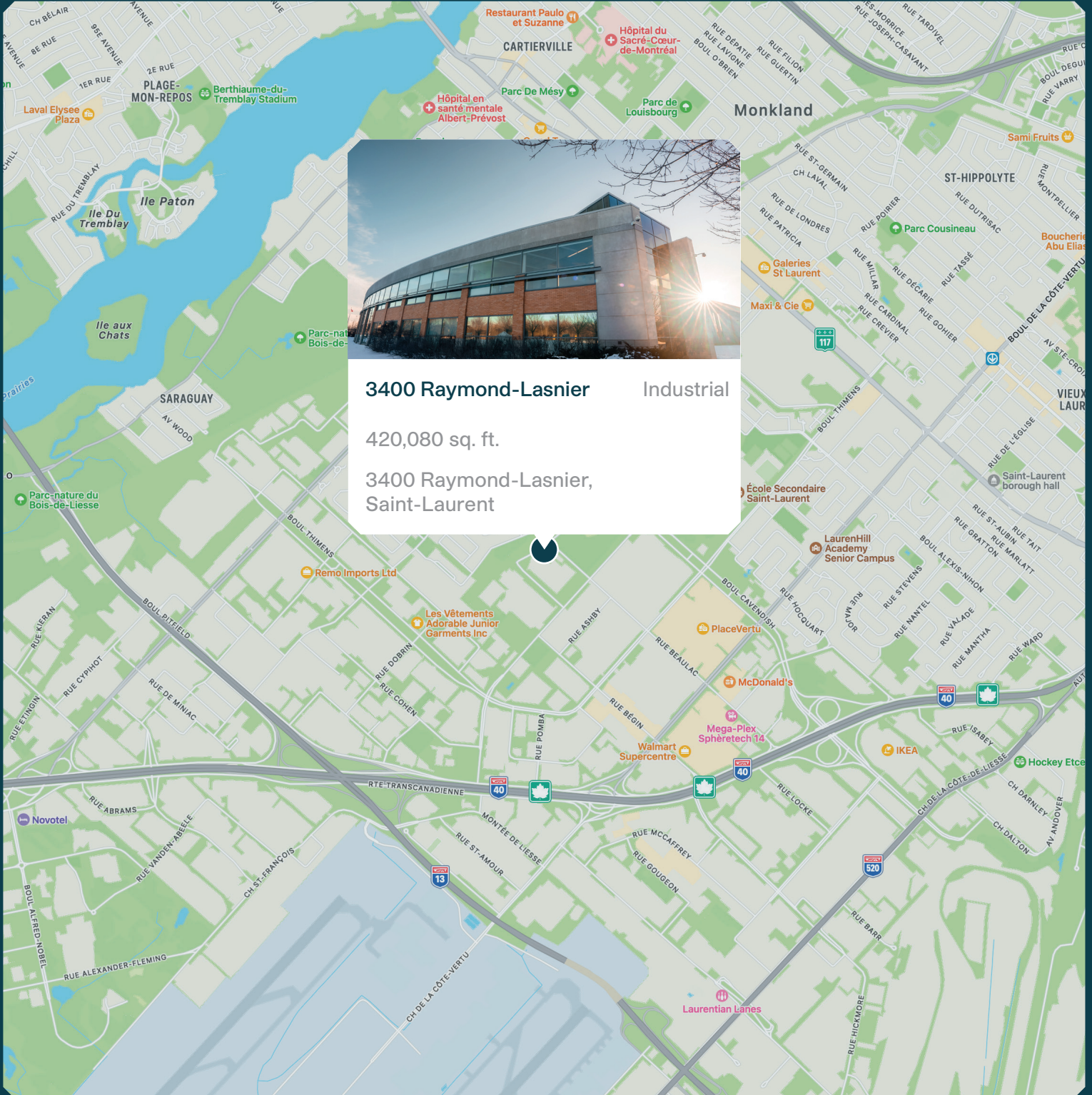



3400 Raymond-Lasnier Industrial

420,080 sq. ft.

3400 Raymond-Lasnier,
Saint-Laurent

Neighborhood Map

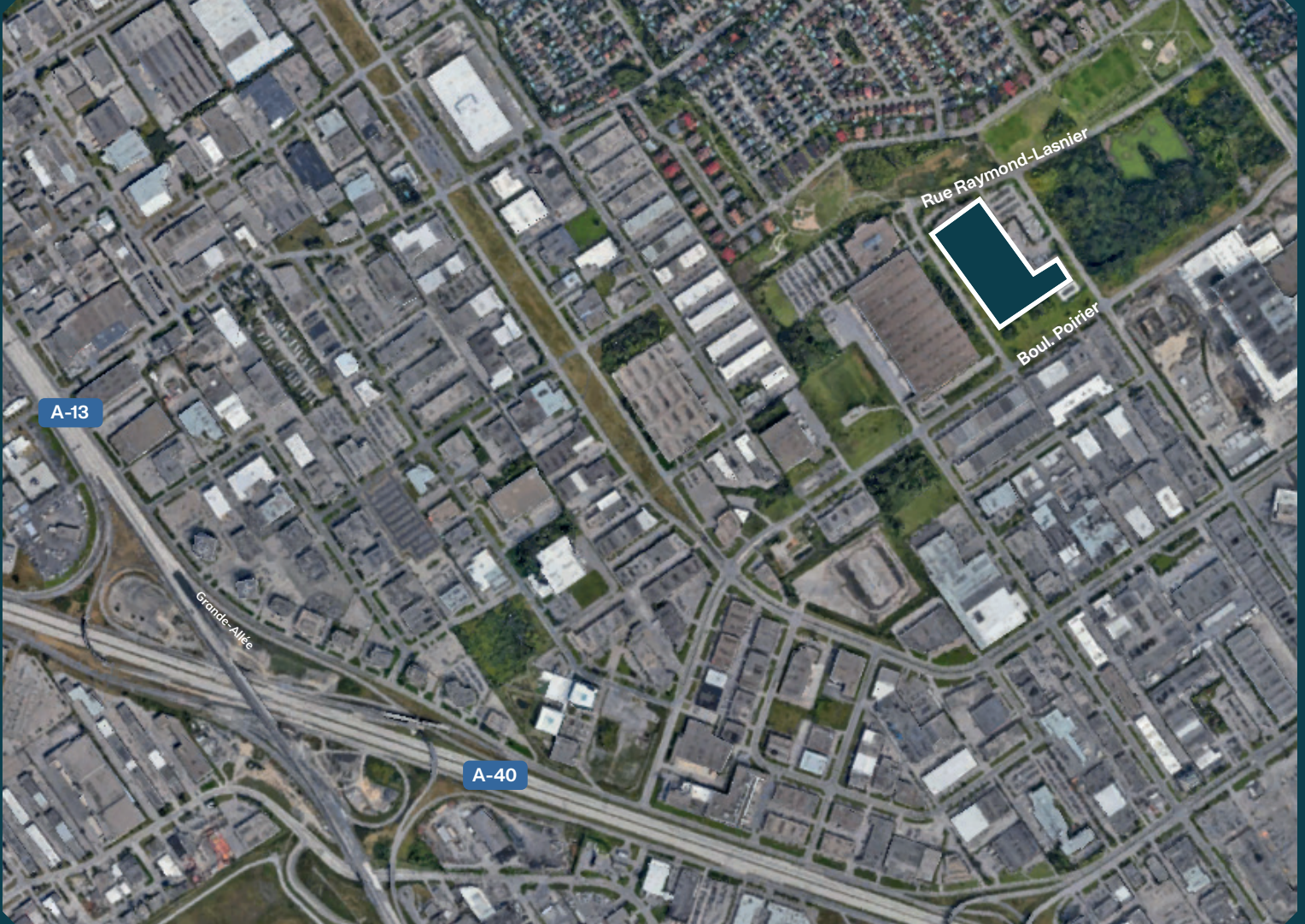

LAND

Total area: 887,221 sq. ft

BUILDING

Available space: 420,080 sq. ft.

ACCESS

Parking spaces available
Easy access to highways 13, 40
Bus 70

Ground floor

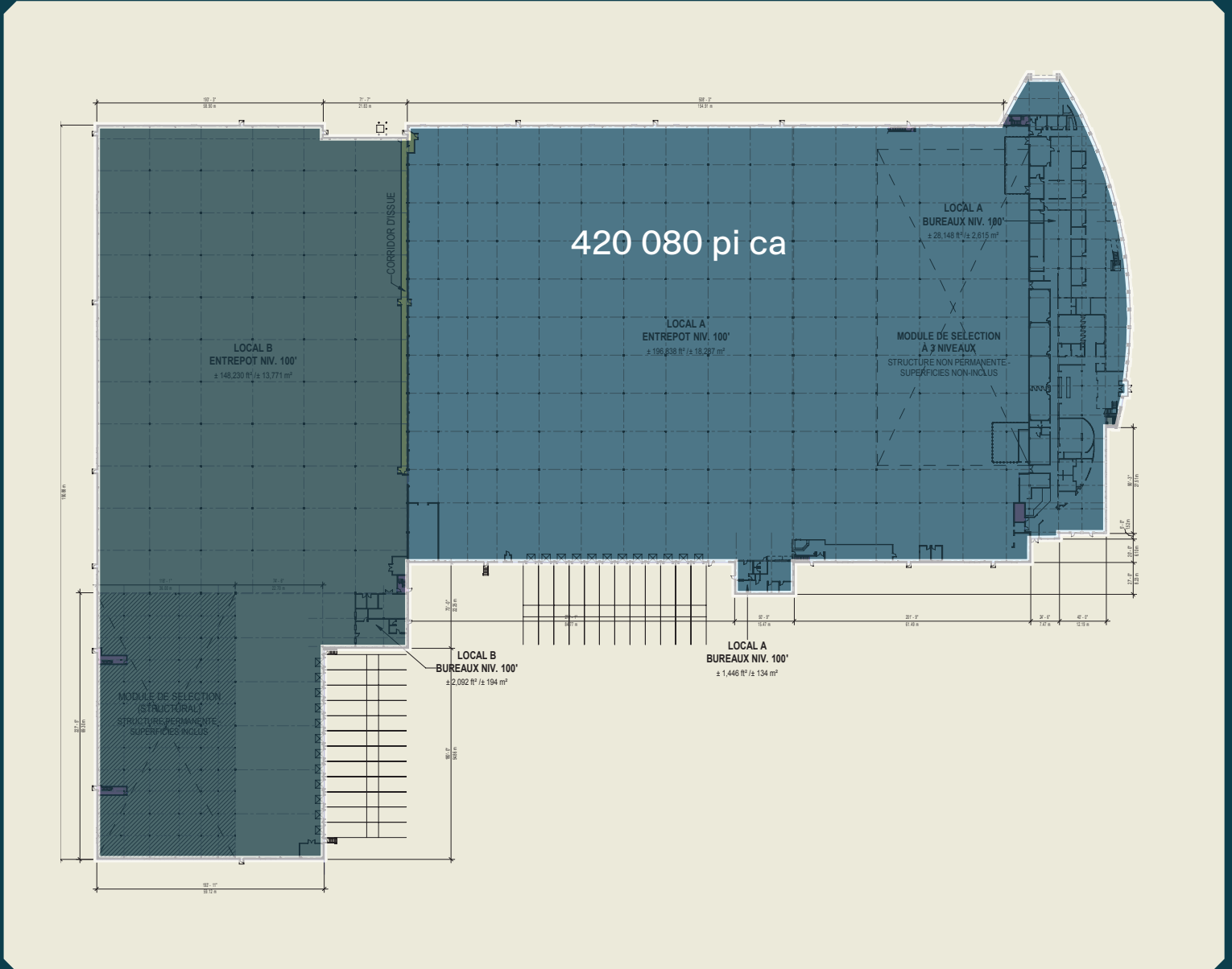

Photos



Photos



Summary



Certification aimed

Relevant Information

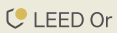

LEED

(Leadership in Energy and Environmental Design) is a rating system recognized in 150 countries and is designed to leave a legacy of high-quality, environmentally friendly buildings with a reduced impact on the environment.

- Available: Early 2024
- Year of construction: 2005
- Total available area: 420,080 sq. ft.
- Garage doors "Drive-in" : Total of one (1) door
- Loading dock doors : Total of twenty six (26) doors
- Clear Height - Warehouse: 30 ft.
- Electrical capacity of the building - 2,000 A
- Warehouse lighting - LED
- Trailer parking spaces - 35 spaces

MONTONI

For any questions related to this
presentation, please contact:
abouchard@groupemontoni.com