

7250 Marconi

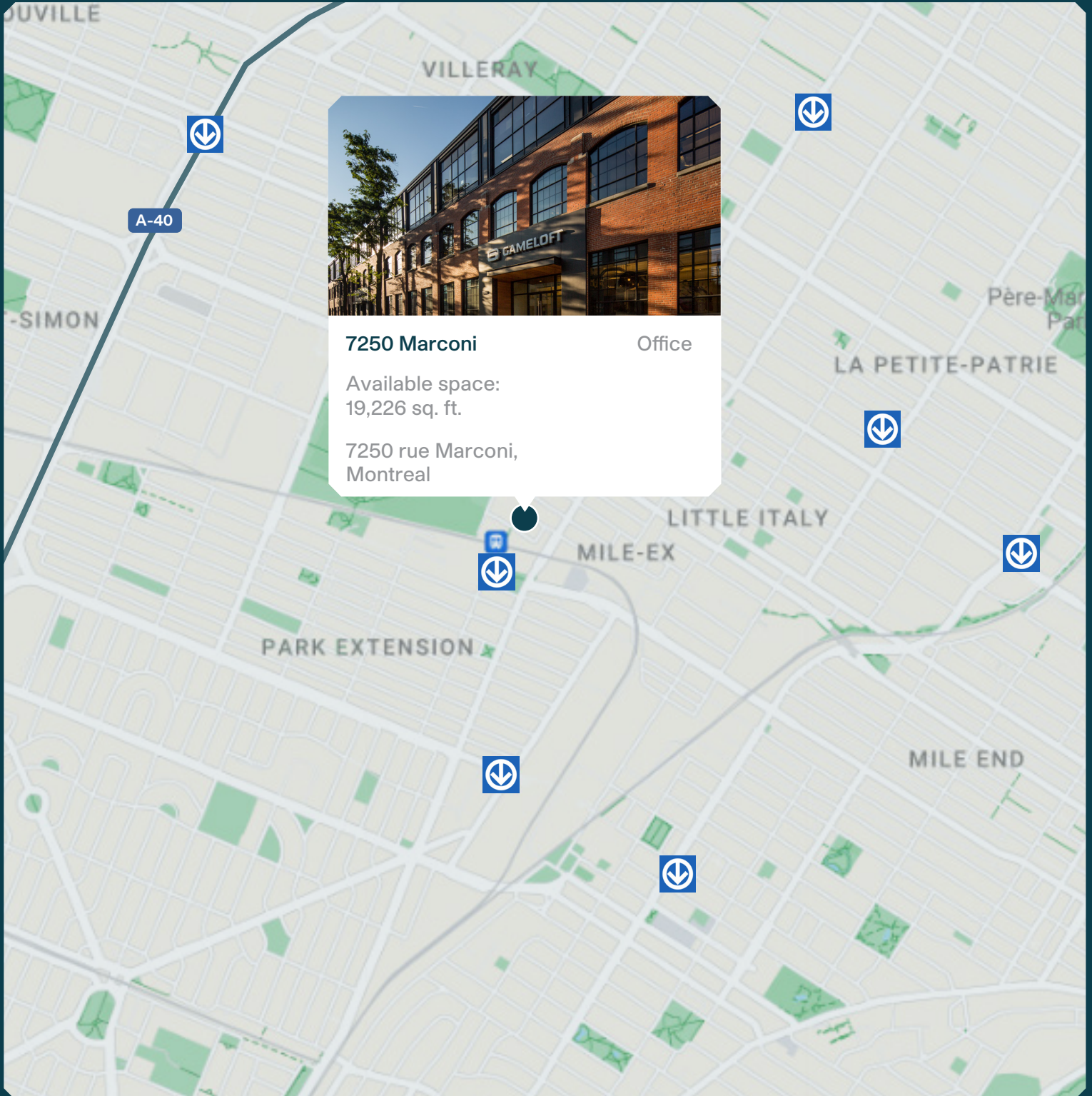



7250 Marconi Office

Available space:
19,226 sq. ft.

7250 rue Marconi,
Montreal

Neighborhood Map



AVAILABLE SPACE

Ground floor - 19,226 sq. ft.

ACCES

Walking distance to metro du Parc and De Castelnau
Easy access to highways 15, 40

Ground Floor Plan

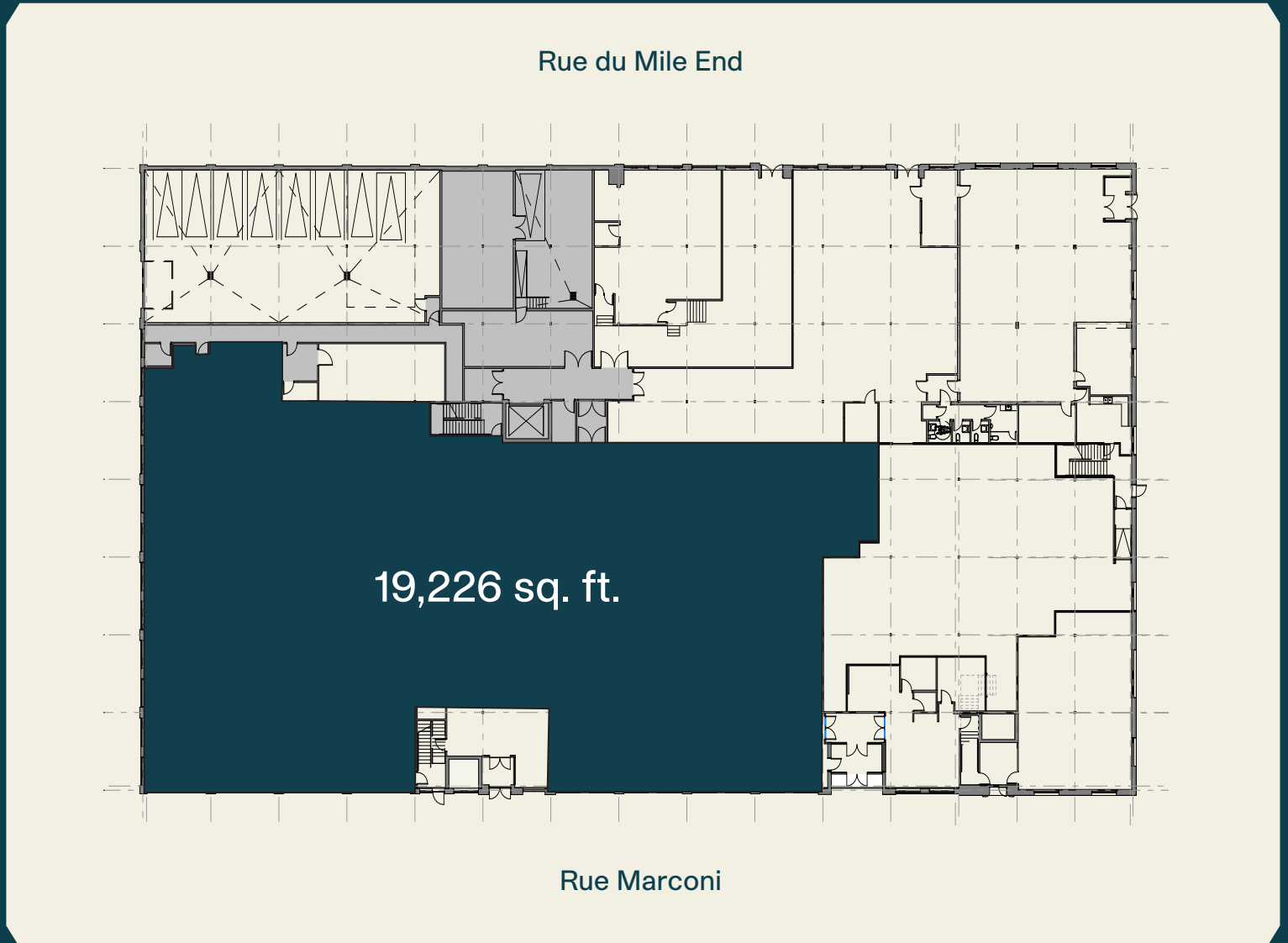

Stacking plan



OCCUPIED SPACES

Ground floor

Marc Cain - 14,976 sq. ft.
Shneider Electric - 3,015 sq ft

2nd Floor

Gameloft - 47,649 sq. ft.

3rd Floor

Schneider Electric - 22,770 sq. ft.
Média Experts - 20,628 sq. ft.

Interior photos



Summary



Certifications



LEED

(Leadership in Energy and Environmental Design) is a rating system recognized in 150 countries and is designed to leave a legacy of high-quality, environmentally friendly buildings with a reduced impact on the environment.

Informations pertinentes

- Available space : 19,226 sq. ft.
- Parking spaces available on request

MONTONI

For any questions related to this
presentation, please contact:
abouchard@groupemontoni.com