

950 Beaumont

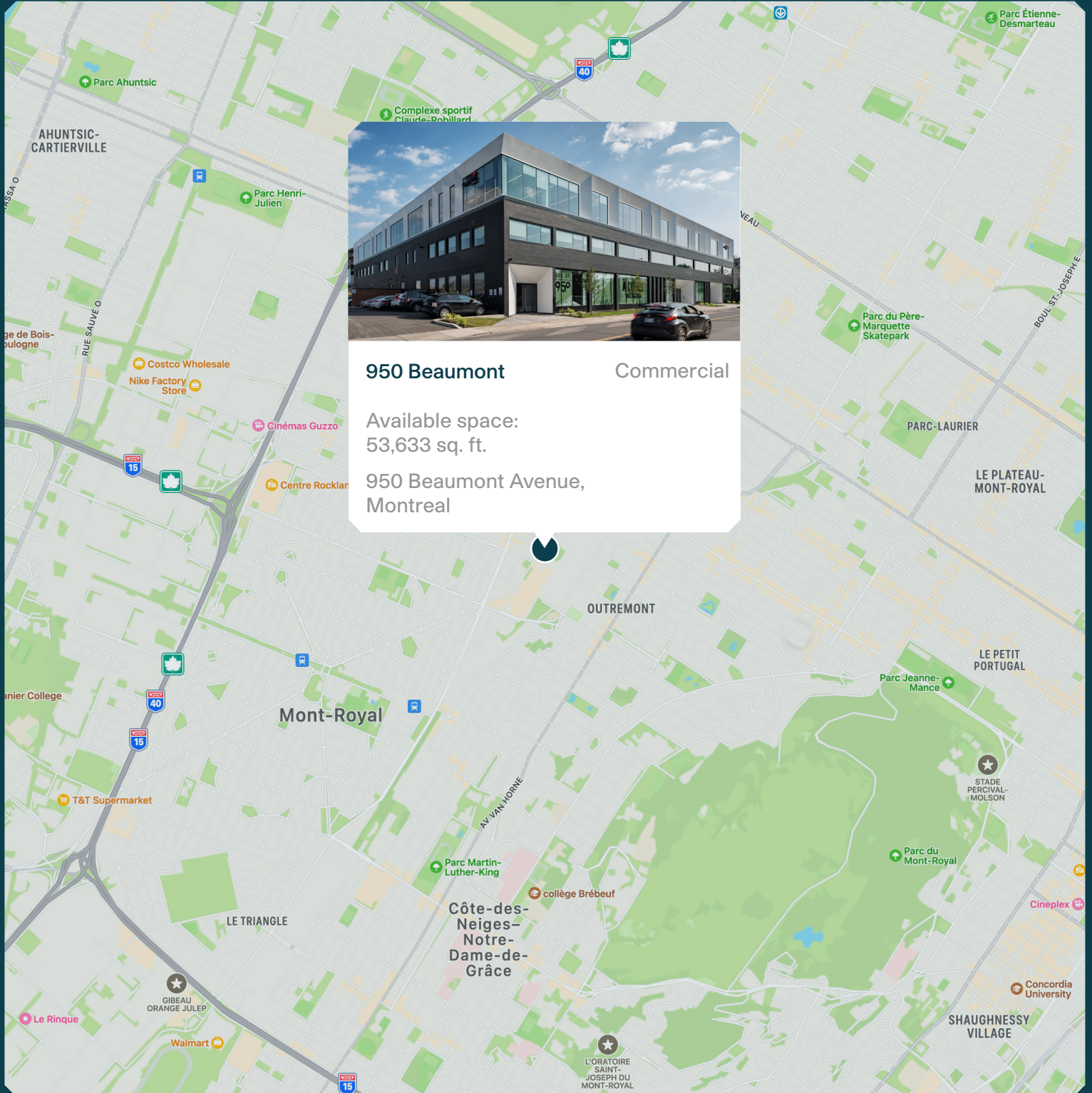

MONTONI

Building on our word
for tomorrow



950 Beaumont Commercial

Available space:
53,633 sq. ft.

950 Beaumont Avenue,
Montreal

Neighbourhood Map

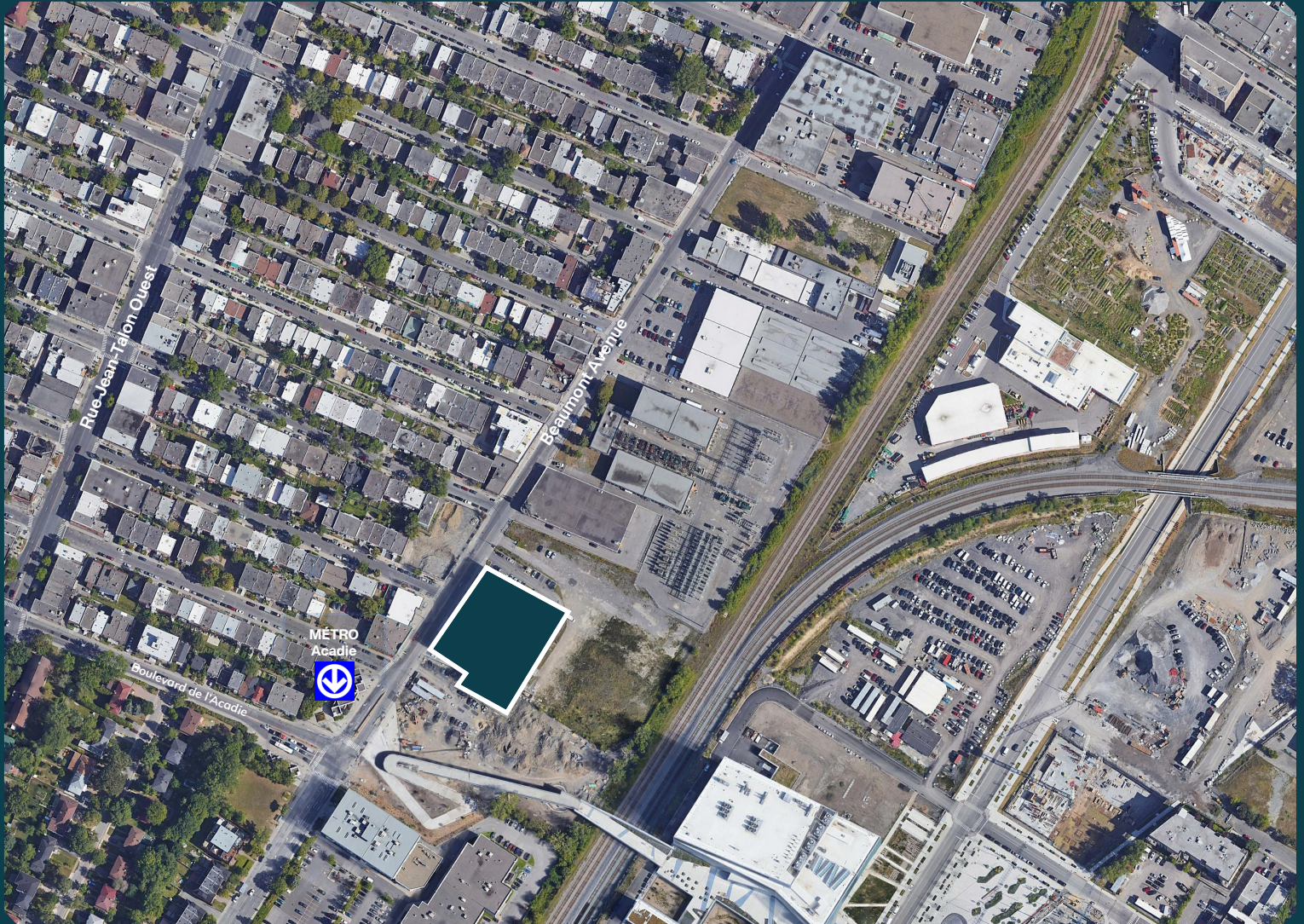

AVAILABLE SPACE

Total available space - 53,633 sq. ft.
Ground floor - 15,637 sq. ft.
Third floor - 37,996 sq. ft.

ACCESS

950 Beaumont Avenue, Montreal
Easy access to highways 15, 40
Across from Metro Acadie
Close proximity to Montréal-Trudeau International Airport

Neighbourhood Map

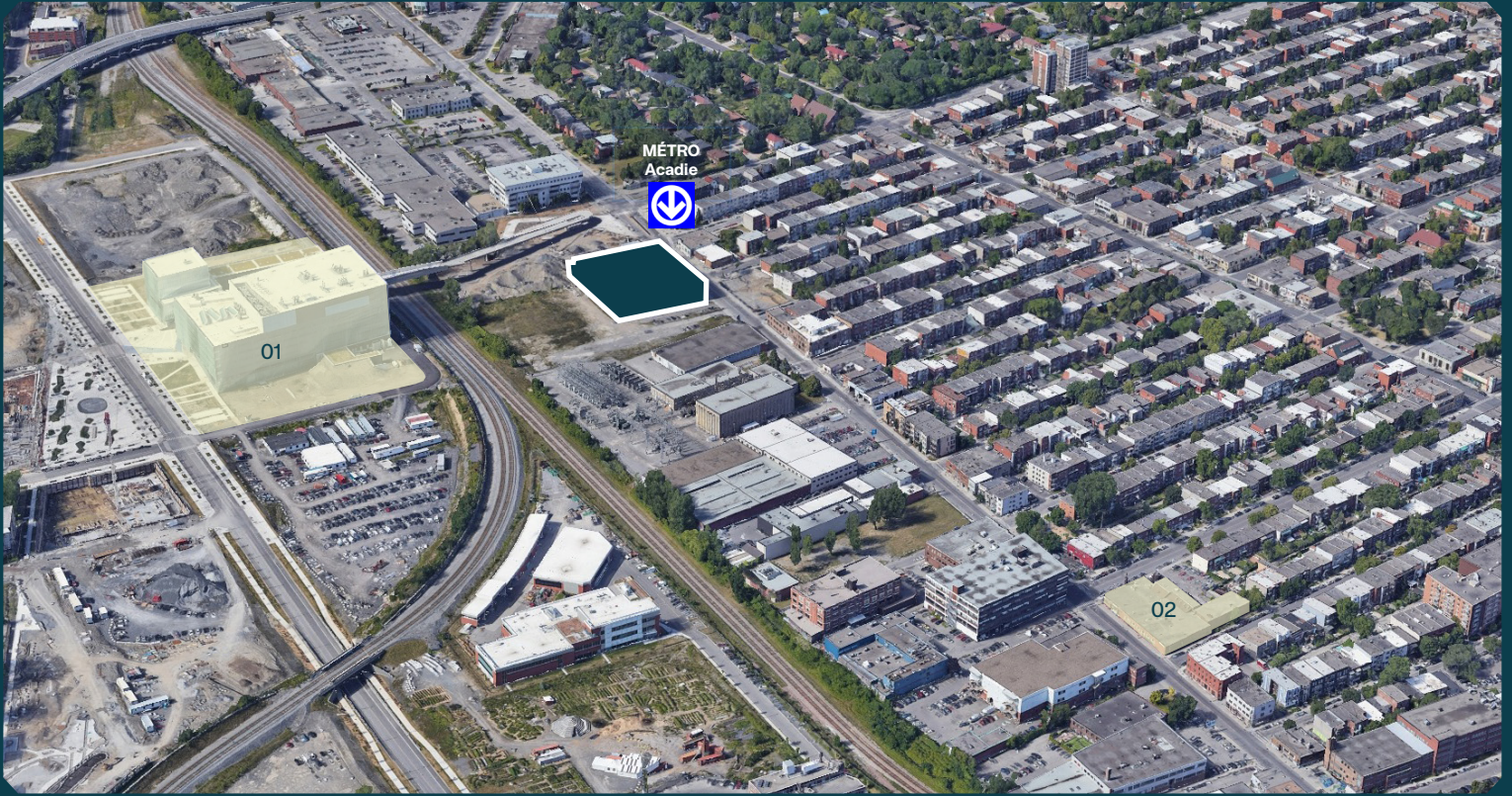

01 - University of Montreal - Campus MIL

02 - Le 495

Ground Floor Plan



01 - 3,187 sq. ft.

02 - 12,450 sq. ft.

Ground Floor Plan

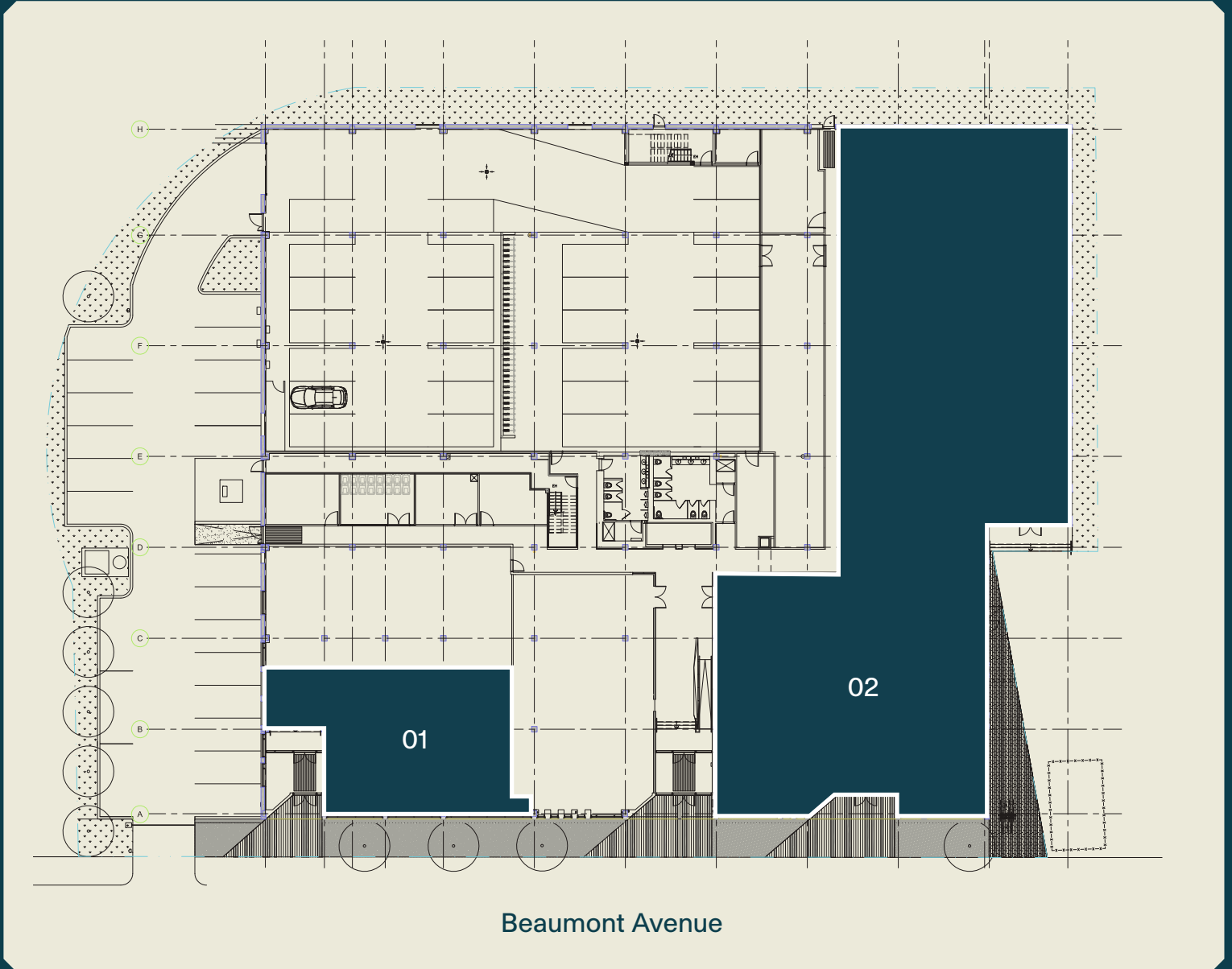

01 - 3,187 sq. ft.

02 - 12,450 sq. ft.

3rd Floor Plan

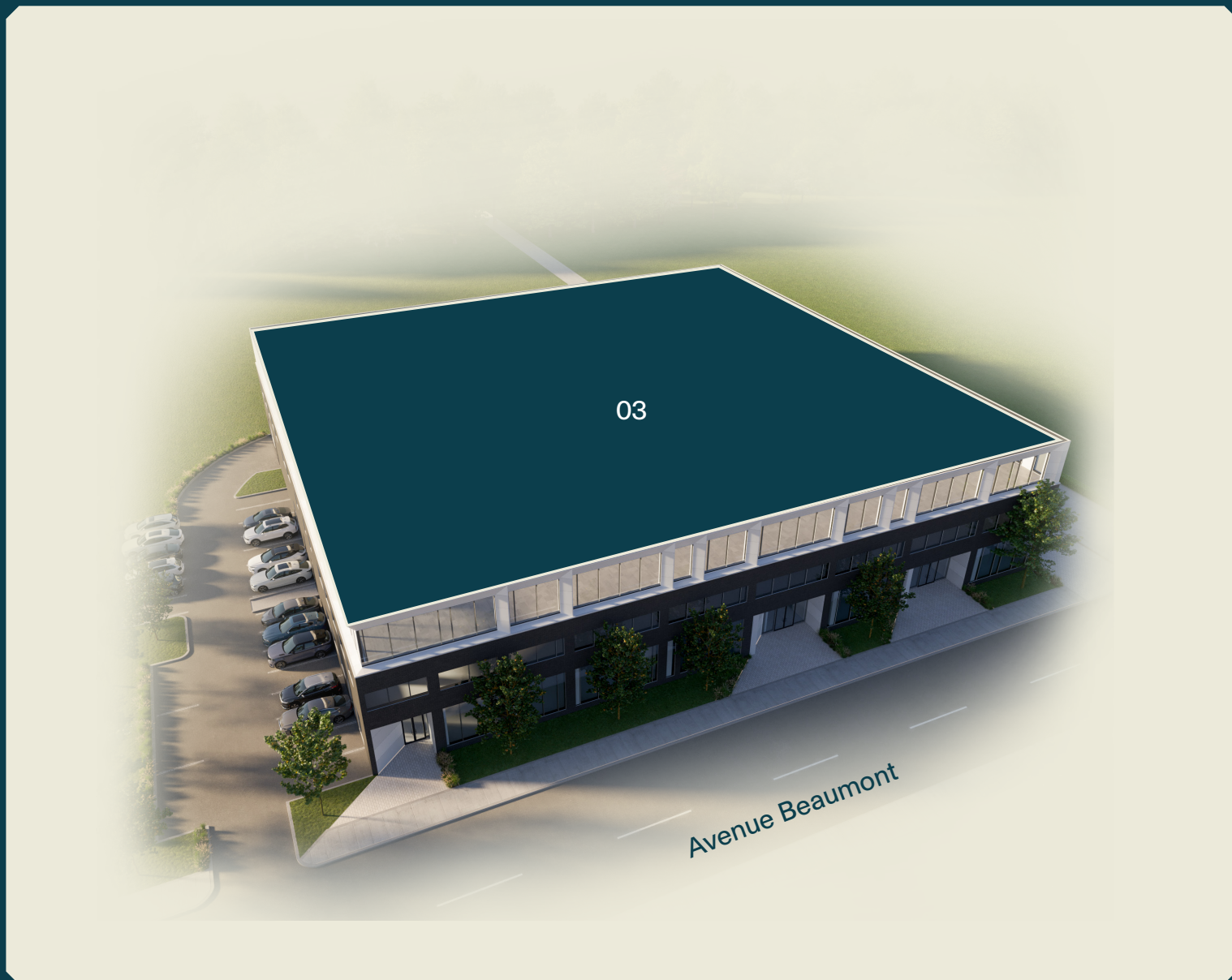

03 - 37,996 sq. ft.

3rd Floor Plan

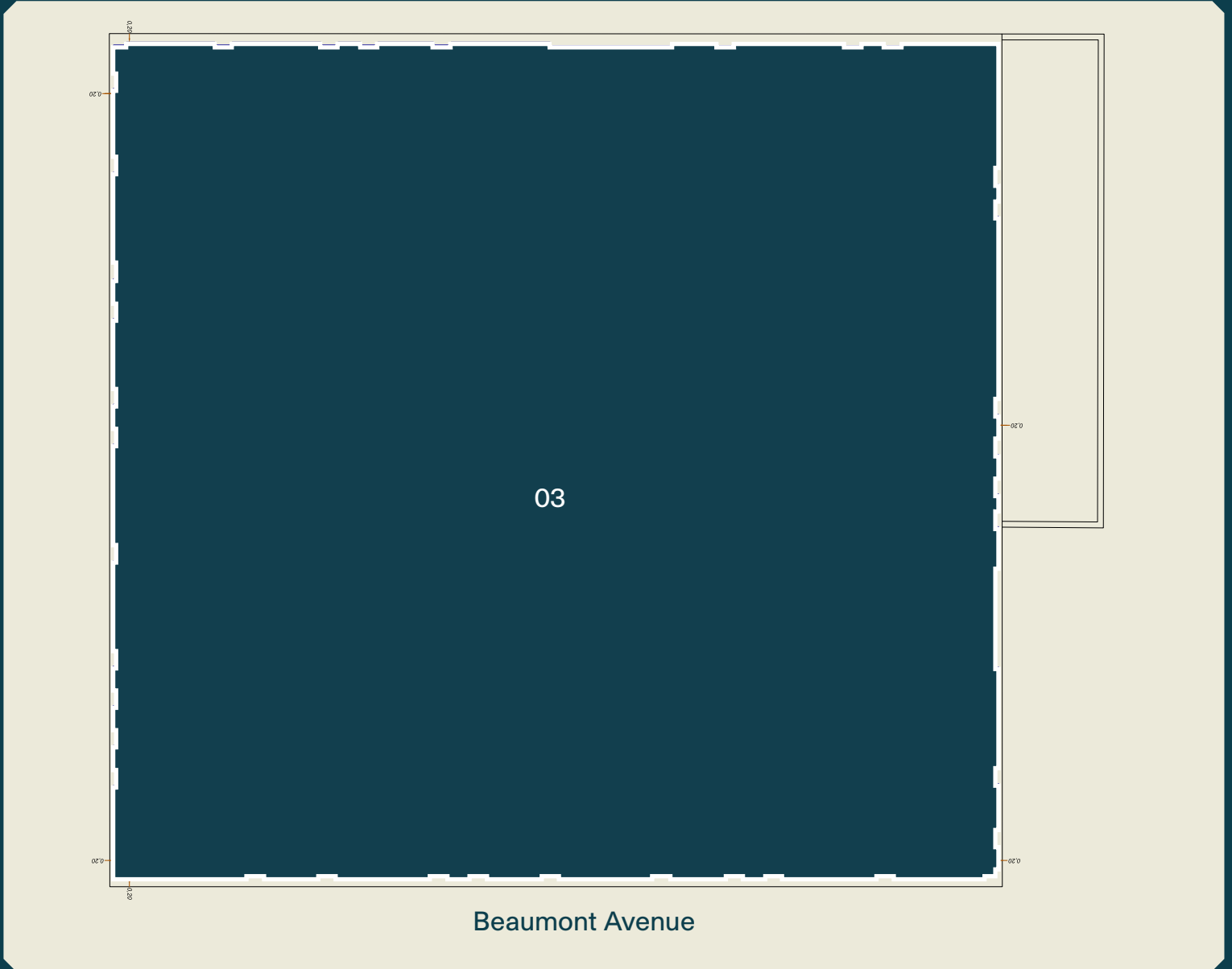

03 - 37,996 sq. ft.

Photos



Summary



Certifications



LEED

(Leadership in Energy and Environmental Design) is a rating system recognized in 150 countries and is designed to leave a legacy of high-quality, environmentally friendly buildings with a reduced impact on the environment.

Relevant Information

- Year of construction - 2018
- Available - Immediately
- Available space:
 - Ground floor - 15,637 sq. ft.
 - 3rd floor - 37,996 sq. ft.
 - Total - 53,633 sq. ft.

MONTONI

For any questions related to this
presentation, please contact:
abouchard@groupemontoni.com