

950 Beaumont

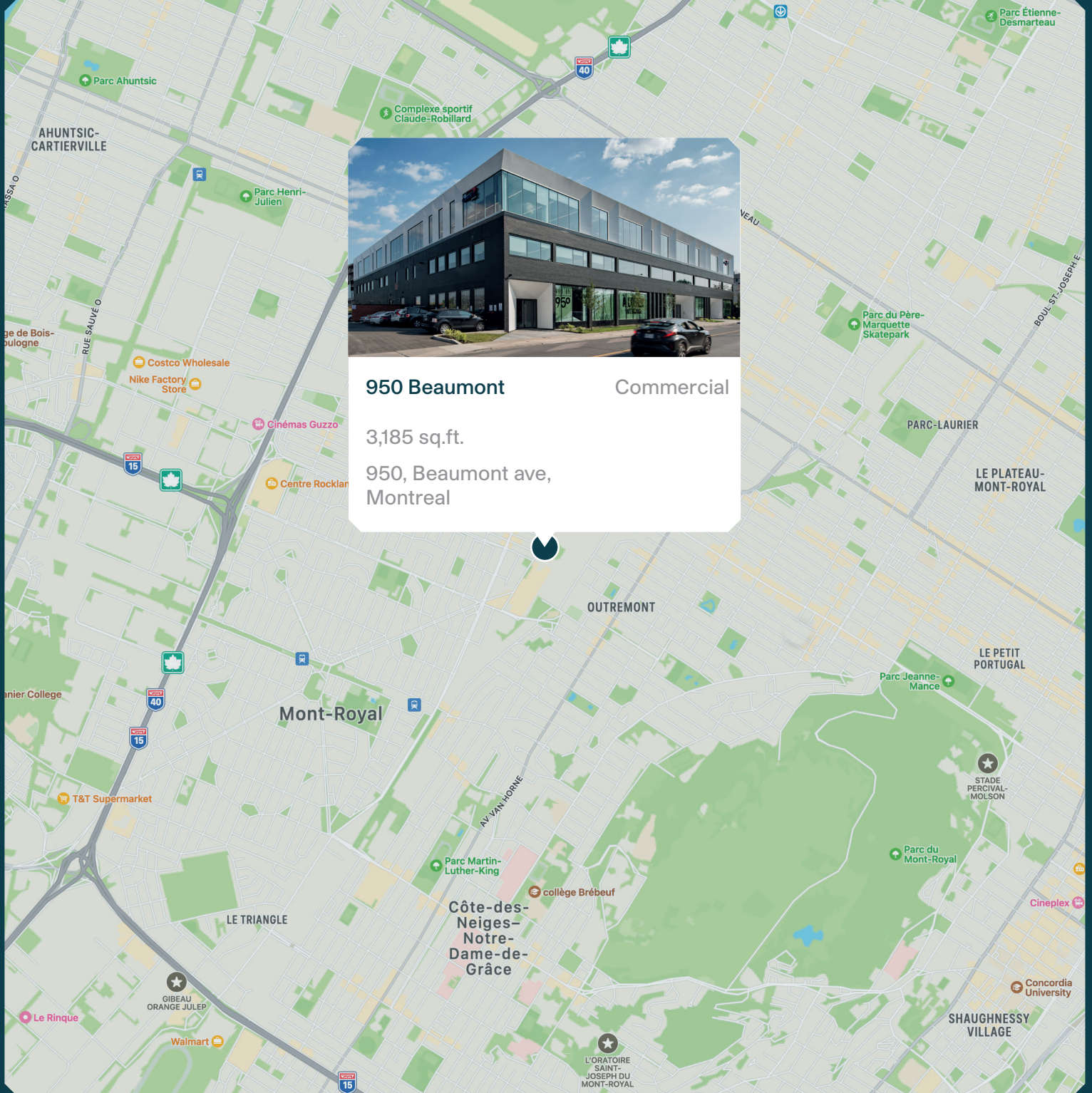

MONTONI

Building on our word
for tomorrow



950 Beaumont Commercial
3,185 sq.ft.
950, Beaumont ave,
Montreal

Neighborhood Map



BUILDING

Total space: 100,210 sq. ft.
Available space : 3,185 sq. ft. (GF)
Clear height : 10"

ACCESS

950 Beaumont avenue, Montreal
Parking spaces available
Easy access to highways 15, 40
Bus 179, Metro Acadie & Metro Parc
Close proximity to Montréal-Pierre Elliott
Trudeau International Airport

FINANCING

Operating costs : 12,73\$ /sq. ft.
Leasehold improvements : 25\$ /sq. ft.
Public utilities : Metered

Ground Floor Plan

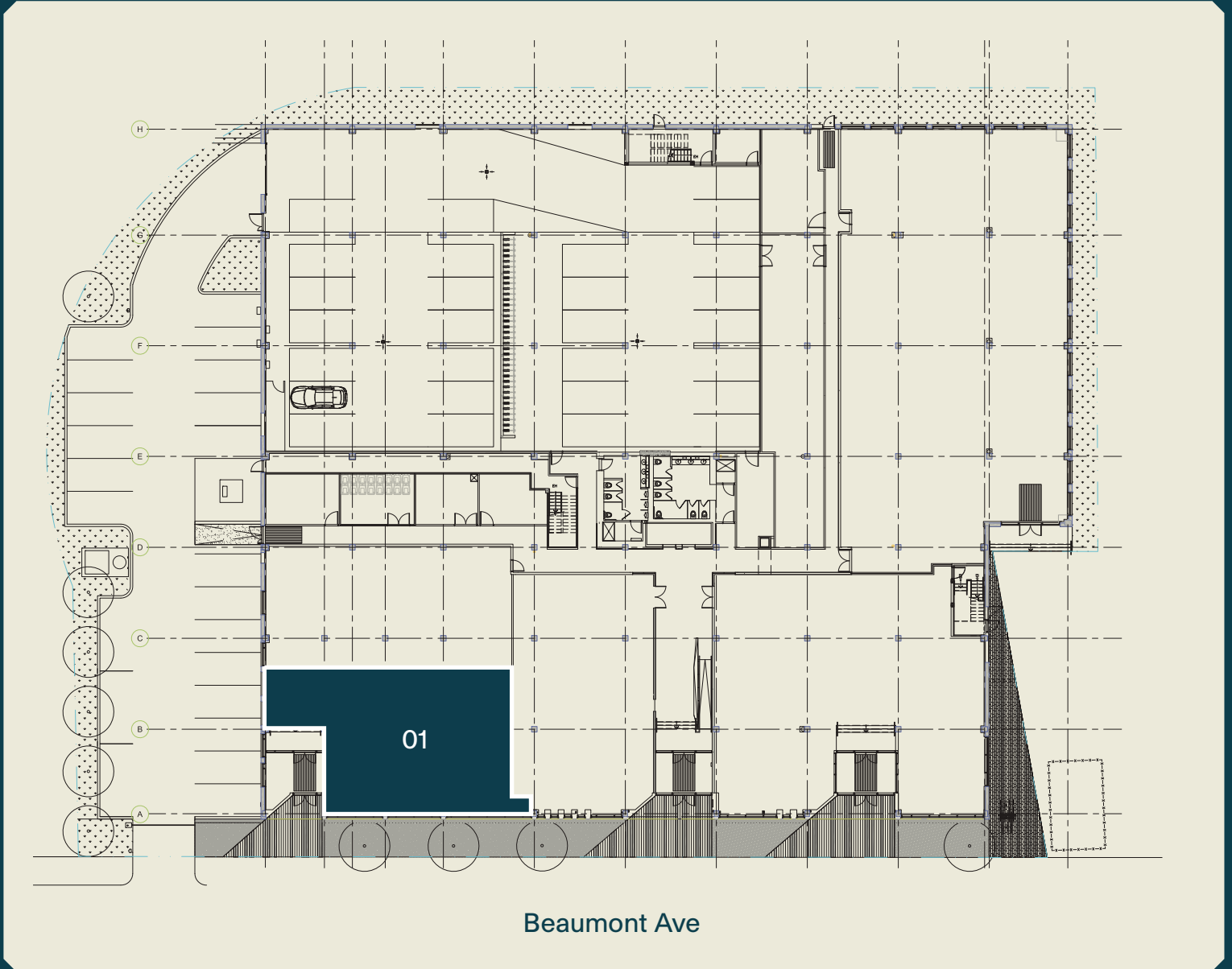

01 - 3,185 sq. ft.

Perspectives



Summary



Certifications aimed

Relevant Information



LEED

(Leadership in Energy and Environmental Design) is a rating system recognized in 150 countries and is designed to leave a legacy of high-quality, environmentally friendly buildings with a reduced impact on the environment.

- Total area : 100,210 sq. ft.
- Available space : 3,185 sq. ft.

MONTONI

For any questions related to this
presentation, please contact:
abouchard@groupemontoni.com