

# Ericsson Campus

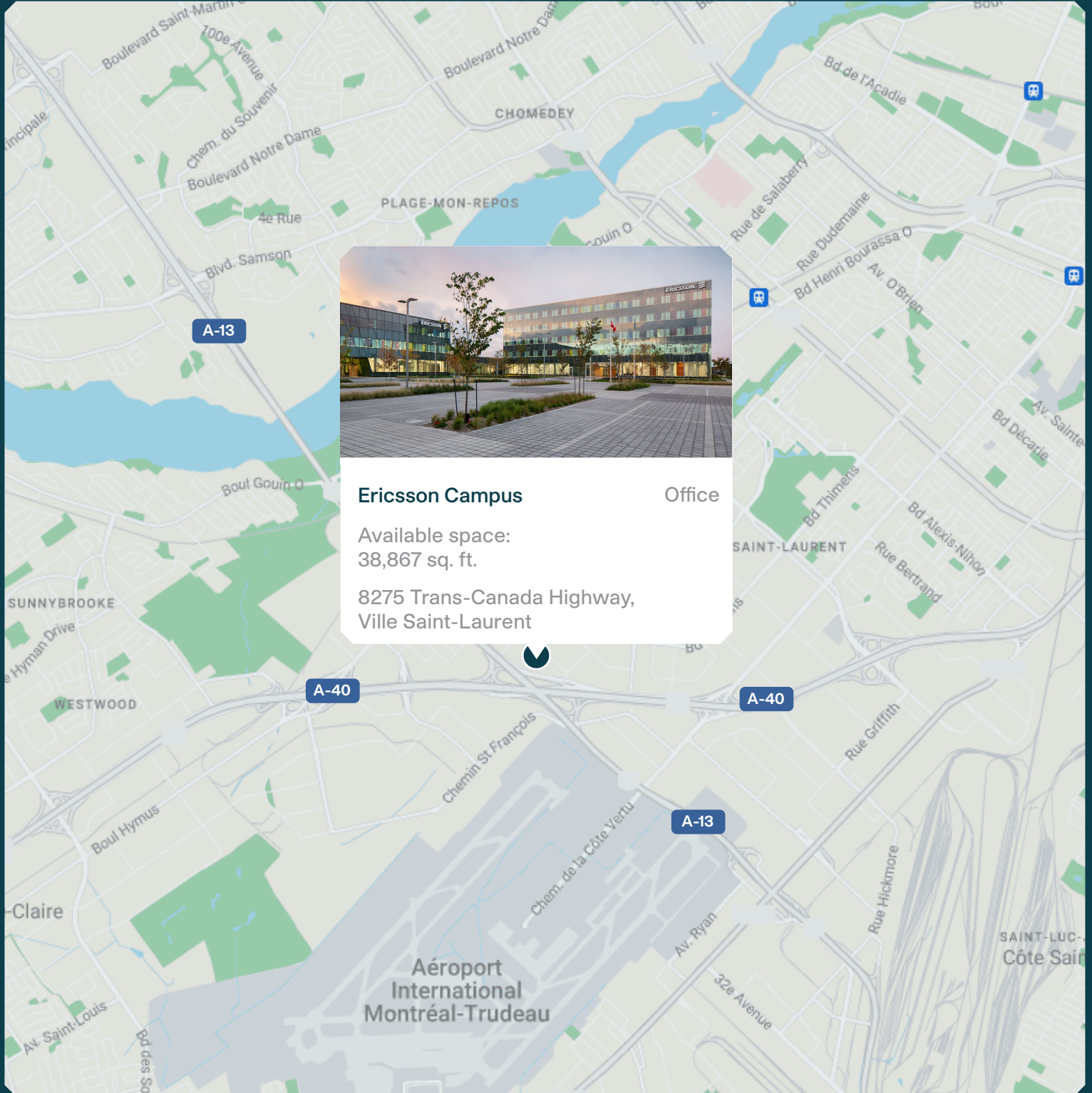



**Ericsson Campus** Office

Available space:  
38,867 sq. ft.

8275 Trans-Canada Highway,  
Ville Saint-Laurent

# Neighbourhood Map



## AVAILABLE SPACE

**Tower A**  
4th floor - 7,266 sq. ft.

**Tower B**  
Ground floor - 5,558 sq. ft.  
3rd floor - 26,043 sq. ft.

## ACCESS

8275 Trans-Canada Highway,  
Ville Saint-Laurent  
Easy access to highways 13, 40

# Stacking Plan



# Site Plan

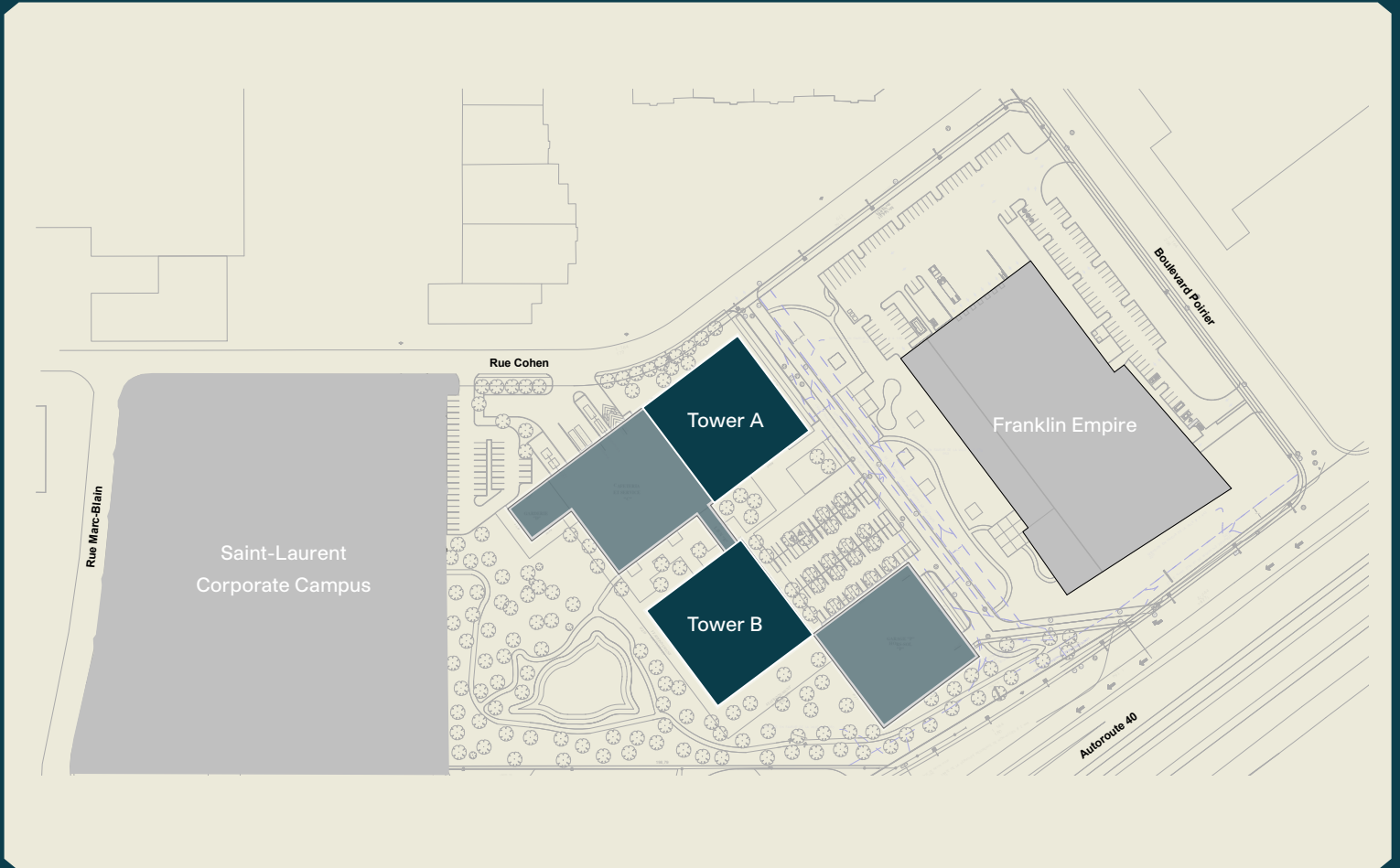

## Tower A

4th floor - 7,266 sq. ft.

## Tower B

Ground floor - 5,558 sq. ft.

3rd floor - 26,043 sq. ft.

# Tower A - 4th Floor Plan





# Tower B - Ground Floor Plan







# Tower B - 3rd Floor Plan



# Tower B - 3rd Floor Plan

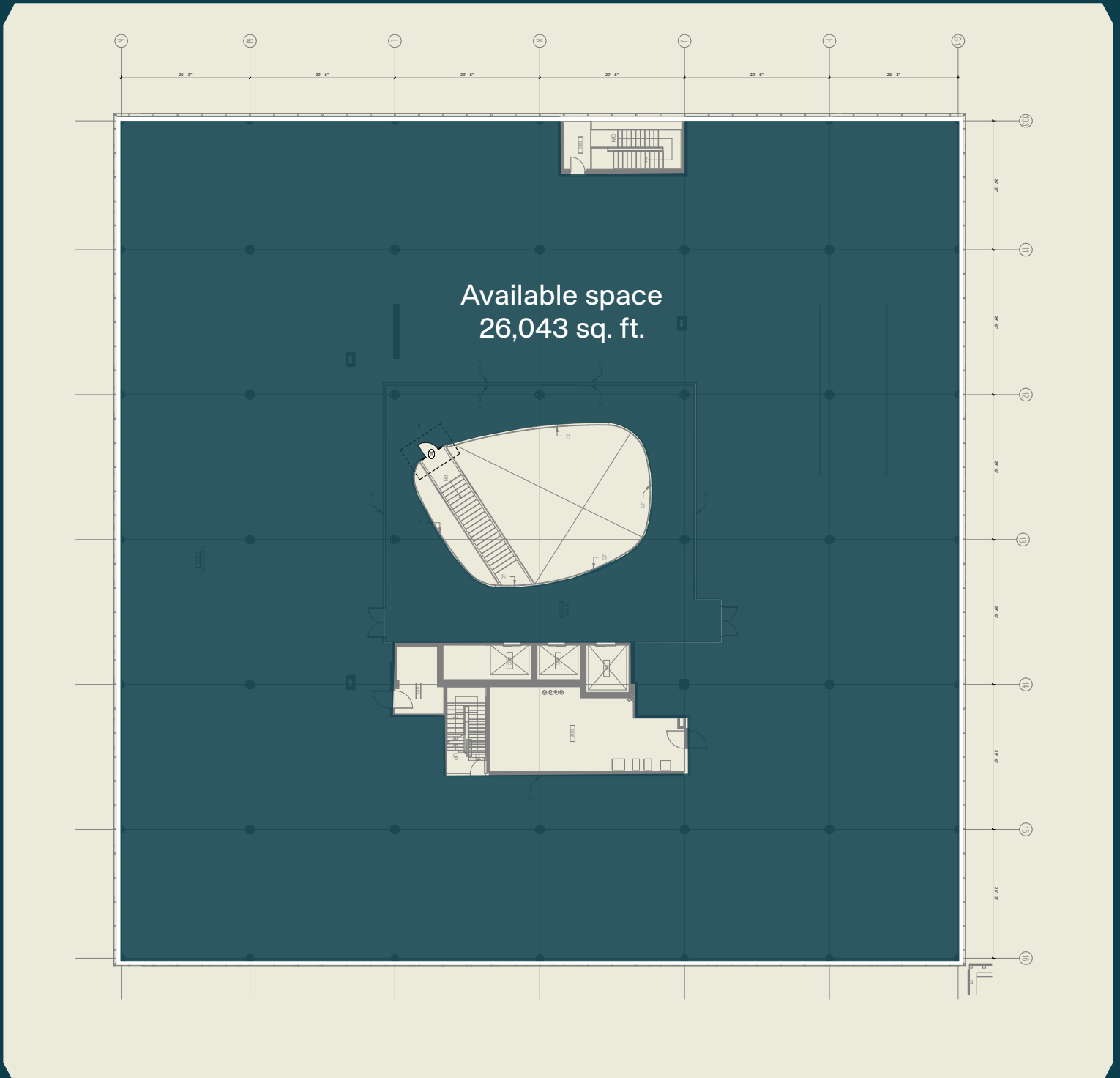

# Photos



# Summary



## Certifications



### LEED Gold

(Leadership in Energy and Environmental Design) is a rating system recognized in 150 countries and is designed to leave a legacy of high-quality, environmentally friendly buildings with a reduced impact on the environment.

## Relevant Information

- Year of construction - 2017
- Zoning - Offices
- Available - Immediately
- Available space:
  - Tower A - 4th Floor - 7,266 sq. ft.
  - Tower B - Ground floor - 5,553 sq. ft.
  - Tower B - 3rd floor - 26,043 sq. ft.
  - Total available space - 38,867 sq. ft.
- Parking:
  - Total of 1,190 spaces (indoor/outdoor)
- Loading dock doors:
  - Total of one (1) door
- Drive-in garage doors:
  - Total of two (2) doors
- Additional amenities:
  - Cafeteria
  - Gym
  - Daycare

# MONTONI

For any questions related to this  
presentation, please contact:  
[abouchard@groupemontoni.com](mailto:abouchard@groupemontoni.com)